

## BOLLARDS

# PVC & POLYCARBONATE BOLLARD

Clean, modern styling to complement the appearance of both landscape and structure by day or night. Black textured exterior finish and opal diffuser. Tough PVC body construction and strong moulded polycarbonate head, providing good vandal resistance.



**IP54**



### SECTOR

#### ROOT MOUNT- OPAL LENS

Part No.	Description	Code
<b>Mains</b>		
SBLR150ES	150W mains ES	4491
<b>Fluorescent</b>		
SBLR42HF	42W TC-TE HF	4495
SBLR42HF/E3	42W TC-TE HF E3	4495
<b>Discharge</b>		
SBLR70SON	70W SON-E INT ES	4498
SBLR70MH	70W M/H ES	4498

#### SURFACE MOUNT - OPAL LENS

Part No.	Description	Code
<b>Mains</b>		
SBLS150ES	150W mains ES	4491
<b>Fluorescent</b>		
SBLS42HF	42W TC-TE HF	4495
SBLS42HF/E3	42W TC-TE HF E3	4495
<b>Discharge</b>		
SBLS70SON	70W SON-E INT ES	4498
SBLS70MH	70W M/H ES	4498



#### SPECIFICATION

- Discharge fittings come with lamp
- Mains GLS & Fluorescent require lamp
- Rigid & strong black PVC tube
- Root mounted as standard, Flange Plate versions also available
- Modern aesthetic styling
- IP54 rating
- Opal polycarbonate diffuser as standard
- Easy lamp replacement by three stainless steel Allen bolts in head
- HF control gear standard on CFL models
- Metal base and clear diffuser options available to order

Root Mounted

Surface Mounted

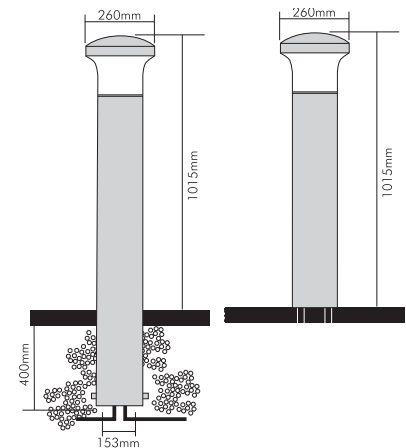

#### ROOT MOUNT LED (Cool White LED) Fresnel Lens

Part No.	Description	Code
SBLR9LEDCW1F	Fresnel 9x1w LED's	4497

#### SURFACE MOUNT LED (Cool White LED) Fresnel Lens

Part No.	Description	Code
SBLS9LEDCW1F	Fresnel 9x1w LED's	4497



#### OPTIONAL FIRST FIX ROOT MOUNTING KIT

Part No.	Description
SBLR1ROOT	Cable management bracket

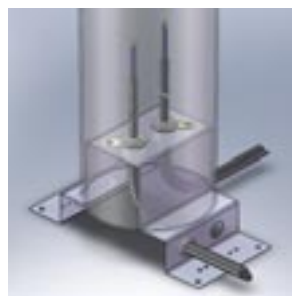

First fix cable management bracket for root mount option.

#### LED SPECIFICATION

- White louvre, clear fresnel diffuser
- Cool white 6500k typical CRI 70 - 1w high power LED chips
- Maintenance free operation fit and forget for life of the product
- 50k hrs = 16.5yrs life @ 3000 hrs per year
- Energy efficient
- Instant light
- Unlimited switching
- No UV emitted from LED's
- Achieving 4.08M spacing between fittings with minimum 10 lux
- 100-265V 0/50/60Hz

#### SUFFIX TABLE:

##### Control Gear Options:

E3 = Integral emergency version (LED & CFL only)

##### Other Options:

/PC = Factory fitted photocell