

HEATRAE SADIA

The quality name in water heating

Boiling water

Supreme | Supreme SS





Supreme BOILING WATER ON DEMAND

Heatrae Sadia's Supreme ranges offer users the ultimate in boiling water solutions.

How much time is wasted every day by staff filling a kettle and waiting for it to heat up? Is it 30 minutes, an hour, more? After putting a value on that time it's easy to calculate how much it costs in a year – just to boil a kettle. Supreme eliminates this waste of time and money by providing a constant supply of boiling water on demand (up to 240 cups of boiling water can be drawn off at any one time – depending on model).



Unlike traditional vending machines, Supreme offers users the opportunity to make an unlimited choice of hot drinks, soups, instant pasta snacks and anything that requires boiling water without many of the associated waste and maintenance issues.

Supreme BOILING WATER ON DEMAND



Supreme is a permanently plumbed, wall mounted electric water heater with an insulated hot water container. Water is heated by an electric heating element and the temperature is controlled within predetermined limits. As boiling water is drawn off, the unit refills with cold water. The replenishment rate allows the element to heat the incoming water as it enters the container so that it only dispenses water at the required temperature. Any steam generated during the heat up cycle is condensed and retained within the unit.

Supreme's flexibility and versatility make it at home in almost any working environment. The busier the company or organisation, the more effective Supreme is. Its simple, instant operation is ideal for a bustling office, shop, factory or hospital - indeed any location where saving time and money is important.

Supreme promotes safe practice; kettles can present safety risks in the workplace. Steam and spilt water can scald people or damage surfaces; plugs and electrical connections are not always properly maintained. Under current Health & Safety legislation, portable appliances such as kettles must be inspected regularly for safety. In today's busy working environment the use of unauthorised electric kettles can overload circuits and lead to the loss of important computer data.

The easy to use lever tap on Supreme is positioned sufficiently far from the spout to ensure steam-free handling. The spout is designed to minimise splashing when dispensing boiling water.

Supreme is offered in seven sizes ranging from the 2.5 litre Supreme 140, suitable for a small office or shop, to the 40 litre Supreme 560 SS, which is ideal for a busy canteen, community hall or hospital where up to 240 cups of boiling water are instantly available.

Typical Supreme applications: Offices, Factories and Warehouses, School and College Staff Rooms, Hospitals and Nursing Homes, Police, Fire and Ambulance Stations, Church Halls, Clubs and Leisure Centres, Prisons and Remand Centres.

Supreme benefit comparisons			
Benefit	Supreme	Standard vending machine	Standard electric kettle
Unlimited choice of hot drinks/snacks	n		n
Immediate availability	n	n	
Low maintenance	n		n
No trailing flex and plug	n	n	
Automatic refill	n	n	
Insulated water container	n	n	
Steam free environment	n	n	
Instant boiling water	n		
Small footprint	n		n
Ideal for teapots, flasks etc.	n		n

Supreme is environmentally friendly. Steam generated during the boiling cycle collects as water droplets across the condensing chamber before dropping down, for recycling, into the water container. This not only conserves energy but ensures that the area around Supreme remains totally steam-free.

Intelliboil™Plus is a patented control system for managing the efficiency of Supreme's boiling cycle. It regularly brings the contents of the water container to the boil in response to ongoing user demand. However, when there has been no draw off for a period of one hour, **Intelliboil™Plus** steps back the stored water temperature. This avoids unnecessary boiling - possibly for a number of hours or even days - until there is renewed user demand. When this occurs, the boiling cycle resumes.

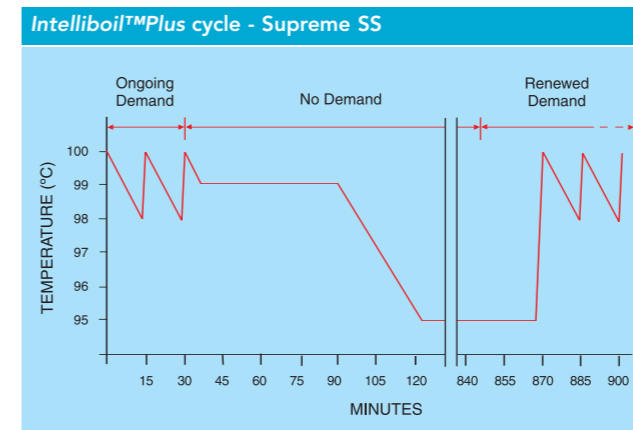

Research shows that many Supreme users switch their units off at weekends, and sometimes overnight, to comply with in-house procedures. When Supreme is switched on again, the 'Temperature Ready' indicator confirms when the contents have reached the correct temperature.

When water boils, problems caused by limescale increase. Water hardness, and the resulting scale formation from boiling, varies significantly throughout the country. In any location, water quality can differ from time to time as supply sources are changed.

As the UK market leader in boiling water technology, Heatrae Sadia has developed an electromagnetic wave generator to reduce limescale formation. This integral unit produces a variable frequency signal that is transmitted into the cold water supply entering Supreme. This treatment alters the structure of calcium carbonate ions contained in the incoming water. As a result, when boiled, they tend not to precipitate onto hot internal surfaces. Instead they remain suspended, harmlessly, in the water. This continuous process does not soften the water, it is totally taint free and has proven effective in a wide variety of water conditions.

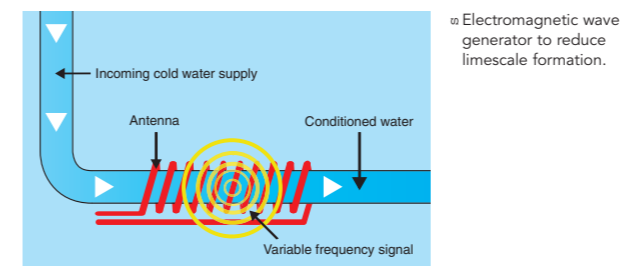

Built to last even longer Supreme's water containers have been designed to withstand the rigours of boiling water. Setting a high standard in resistance to scaling and corrosion. In addition special, low watts density, Superloy immersion heaters are used for longer life expectancy.

Installing Supreme is now easier than ever. Pipework is simple to connect using push-fit fittings. Electrical connections are straightforward and commissioning is now fully automatic. LEDs inform the installer when the commissioning process is complete and the unit is ready for use. A hook-on wall bracket makes mounting quick and easy.

Easy to service and descale, Supreme's integral water conditioner reduces the rate of limescale formation in even the most extreme water conditions. However, in serious cases, the eventual scale formation may still require removal. To make this task quick and easy, Supreme 140 - 180 SS has a detachable steam condensing chamber. Once removed this offers full access to the entire water container. Supreme 220 SS - 560 SS are designed to be swung away from the wall for easy access to the element plate for scale removal.



Supreme 140 - 180 SS have detachable steam condensing chambers. Once removed this offers full access to the entire water container.



Supreme 220 SS - 560 SS swing away from the wall. This allows easy access to element plate for servicing.



Supreme 150 SS / 165 SS / 180 SS

Heatrae Sadia's range of boiling water products are available in an ultra modern fingerprint resistant stainless steel finish. Available in three capacities (2.5 litre, 5.0 litre and 7.5 litre) with a full range of benefits including:



Intelliboil™Plus technology for the efficient management of the boiling cycle

Easy installation with auto-commissioning

Integral electronic water conditioner makes Supreme SS less prone to scale

'Ready' indicator confirms when ready for use

Engineering grade thermoplastic water container

Detachable steam condensing chamber for easy service access

Modular construction ensures easy maintenance

Retains same footprint, service connections and wall fixings as previous models

Satin chrome finished heavy duty die-cast push/pull lever for controlled boiling water delivery

Fingerprint resistant stainless steel outer casing

BEAB approved

kiwa approved to UK Water Supply Regulations

Up to 45 cups immediate draw-off depending on model (150-180 cups per hour based on 167ml cup)

Two-year on-site parts and labour guarantee

Supreme 150 SS / 165 SS / 180 SS capacities					
Model	Cups (167ml)		Mugs (250ml)		Volume litres at one time
	per hr	at one time	per hr	at one time	
Supreme 150 SS	150	15	100	10	2.5
Supreme 165 SS	165	30	110	20	5.0
Supreme 180 SS	180	45	120	30	7.5



Supreme 140 / 155 / 170

Heatrae Sadia's Supreme is available in a high quality white thermoplastic finish with capacities of 2.5 litre, 5.0 litre and 7.5 litre. This compact and elegant model offers a full range of benefits including:



Intelliboil™ technology for the efficient management of the boiling cycle

Easy installation with auto-commissioning

Integral electronic water conditioner makes Supreme less prone to scale

'Ready' indicator confirms when ready for use

Engineering grade thermoplastic water container for longer life expectancy

Detachable steam condensing chamber for easy service access

Modular construction ensures easy maintenance

Retains same footprint, service connections and wall fixings as previous models

Easy to clean white high impact thermoplastic outer casing

BEAB approved

kiwa approved to UK Water Supply Regulations

Up to 45 cups immediate draw-off depending on model (140-170 cups per hour based on 167ml cup)

Two-year on-site parts and labour guarantee

Supreme 140 / 155 / 170 capacities

Model	Cups (167ml)		Mugs (250ml)		Volume litres at one time
	per hr	at one time	per hr	at one time	
Supreme 140	140	15	93	10	2.5
Supreme 155	155	30	103	20	5.0
Supreme 170	170	45	113	30	7.5



Supreme 220 SS / 250 SS / 310 SS / 560 SS

Heatrae Sadia has extended its range of boiling water products through the introduction of four large capacity models. These come in stylish fingerprint resistant stainless steel and can provide up to 560 cups per hour (based on a 167ml cup) and 240 cups at any one time. Benefits of the new range include:



Intelliboil™Plus technology for the efficient management of the boiling cycle

Easy installation with auto-commissioning

Integral electronic water conditioner makes Supreme less prone to scale

'Ready' indicator confirms when ready for use

Supplied with one tap - up to three can be fitted for high demand applications

Lockable satin chrome heavy duty die-cast tap handle for security applications

Hinged mounting bracket for easy service access

3kW element for fast recovery and extra cups per hour (6kW with 560 SS model)

Fingerprint resistant stainless steel outer casing

BEAB approved

kiwa approved to UK Water Supply Regulations

Up to 240 cups immediate draw-off depending on model (220-560 cups per hour based on 167ml cup)

Two-year on-site parts and labour guarantee

Supreme 220 SS / 250 SS / 310 SS / 560 SS capacities

Model	Cups (167ml)		Mugs (250ml)		Volume litres at one time
	per hr	at one time	per hr	at one time	
Supreme 220 SS	220	60	145	40	10
Supreme 250 SS	250	90	165	60	15
Supreme 310 SS	310	150	205	100	25
Supreme 560 SS	560	240	370	160	40



⁰⁰ Lockable die-cast tap for security applications (lock and keys not supplied).



ACCESSORIES

Supreme counter stand.
Allows Supreme 140 / 150 SS or 155 / 165 SS / 170 / 180 SS to be installed in applications where there is insufficient wall space. Manufactured from stainless steel these stands are supplied with a removable drip tray and fixing bolts suitable for counters up to 45mm thick.



Drip tray with waste connection (95:970:123) can be ordered separately for use with the larger counter stand (95:970:133).

Stainless steel drip tray. This accessory completes a professional installation - designed to be inset into a work surface. Available with a 1/4" BSP waste outlet connection. Free-standing version, without waste fitting, also available.

Inset drip tray with waste

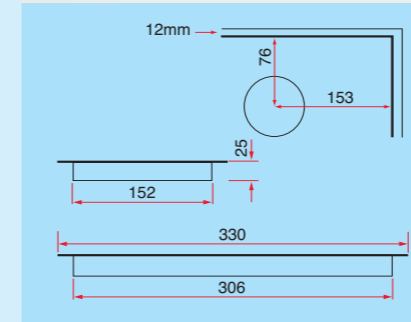

Free standing drip tray

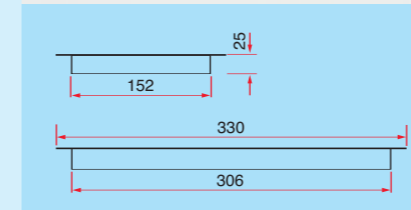

Selection guide for accessories

Model	Additional tap	Drip tray	Counter stand	Digital programmer
Supreme 140		n	n	n
Supreme 155		n	n	n
Supreme 170		n	n	n
Supreme 150 SS		n	n	n
Supreme 165 SS		n	n	n
Supreme 180 SS		n	n	n
Supreme 220 SS	n	n		n
Supreme 250 SS	n	n		n
Supreme 310 SS	n	n		n
Supreme 560 SS	n	n		n

Supreme can be programmed to be switched on and off, on a daily basis. This ensures greater economy when premises are unoccupied for extended periods. This optional accessory allows up to 42 switching operations per week and is integrated into a fused spur unit (not suitable for use with Supreme 560 SS).

Up to 42 switching operations per week

Simple two button programming

Self-cancelling override

Integral double pole switch and BS1362 fuse

1000 hour rechargeable memory backup

Voltage free contacts

Fits on to a 25mm deep, single gang wall box

85mm x 85mm x 38mm

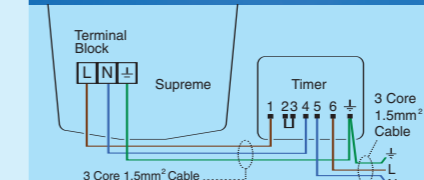

The water filter system reduces impurities, odours and unpleasant tastes. Supplied with connecting hoses and a head for permanent installation. The head incorporates an integral shut-off valve, to facilitate quick and simple replacement of the filter cartridge, which should be replaced after one year or 11,000 litres, whichever is earliest.



Additional taps can be fitted to either side of the Supreme 220 SS / 250 SS / 310 SS / 560 SS units for convenience in high usage applications.



Accessories ordering guide

	Product code
7 day digital programmer	95:970:124
Drip tray with waste	95:970:123
Drip tray no waste	95:970:128
Counter stand 140 / 150 SS	95:970:132
Counter stand 155 / 165 SS / 170 / 180 SS	95:970:133
Additional tap for Supreme 220 SS / 250 SS / 310 SS / 560 SS	95:970:402
Water filter system	95:970:129
Replacement filter cartridge	95:970:130

Supreme 150 SS / 165 SS / 180 SS

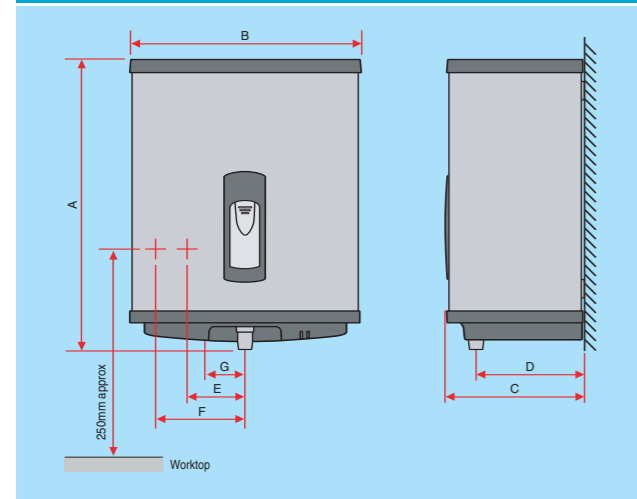

Dimensions							
Model	Height A mm	Width B mm	Depth C mm	Outlet D mm	Inlet E mm	Vent F mm	Cable G mm
Supreme 150 SS	423	337	203	160	80	112	111
Supreme 165 SS	501	337	203	160	101	133	101
Supreme 180 SS	506	337	262	220	101	133	101

Capacities					
Model	Cups (167ml)		Mugs (250ml)		Volume litres at one time
	per hr	at one time	per hr	at one time	
Supreme 150 SS	150	15	100	10	2.5
Supreme 165 SS	165	30	110	20	5.0
Supreme 180 SS	180	45	120	30	7.5

Specification

Capacities Supreme 150 SS 2.5l max 150 cups/hr, Supreme 165 SS 5.0l max 165 cups/hr, Supreme 180 SS 7.5l max 180 cups/hr.

Rating 2.5kW @ 240V (2.3kW @ 230V).

Outer casing Fingerprint resistant stainless steel with grey ABS mouldings.

Thermal insulation CFC/HCFC free (ODP zero) pre-moulded polystyrene and thermoplastic blend.

Water container Moulded Polyphenylene Sulphide. Removable steam condensation chamber for maintenance access.

Heat unit Low watts density Superloy element for long life.

Thermostat Electronic to control water temperature up to boiling point.

Safety features All models are low pressure vented. Dry start protection by self re-setting bi-metal thermal cut out. Boil dry by protection by manually re-settable disc-type bi-metal cut out.

Installation

Fixing Supreme units have a fixing template and hook-on brackets for wall mounting, ideally over a draining board or drip-tray. Clearance should be allowed all around the unit for maintenance (refer to instructions).

Plumbing Cold water feed should be taken directly from the mains – min pressure 0.5 bar (7psi) max pressure 10 bar (145psi). Bottom or rear entry is possible using 15mm push-fit connections.

Electrical Supply (bottom or rear entry) 2.5kW units can be taken from a suitable ring final circuit via a fused spur but must be via a double-pole linked isolating switch with a minimum break capacity of 13A.

All electrical work must comply with the latest IEE wiring regulations.

Supreme 140 / 155 / 170

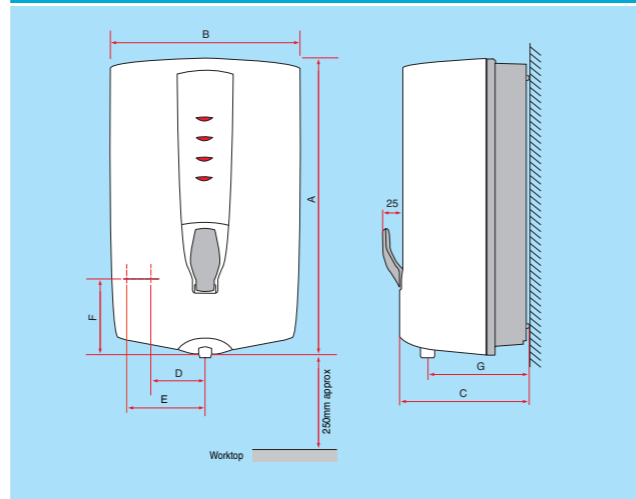

Dimensions								
Model	Height A mm	Width B mm	Depth C mm	Inlet D mm	Vent E mm	F mm	G mm	Add for tap mm
Supreme 140	445	290	190	80	115	105	150	25
Supreme 155	510	335	205	100	130	100	160	25
Supreme 170	510	335	260	100	130	100	230	25

Capacities					
Model	Cups (167ml)		Mugs (250ml)		Volume litres at one time
	per hr	at one time	per hr	at one time	
Supreme 140	140	15	93	10	2.5
Supreme 155	155	30	110	20	5.0
Supreme 170	170	45	113	30	7.5

Specification

Capacities Supreme 140 2.5l max 140 cups/hr, Supreme 155 5.0l max 155 cups/hr, Supreme 170 7.5l max 170 cups/hr.

Rating 2.5kW @ 240V (2.3kW @ 230V).

Outer casing White high-impact thermoplastic.

Thermal insulation CFC/HCFC free (ODP zero) pre-moulded polystyrene and thermoplastic blend.

Water container Moulded Polyphenylene Sulphide. Removable steam condensation chamber for maintenance access.

Heat unit Low watts density Superloy element for long life.

Thermostat Electronic to control water temperature up to boiling point.

Safety features All models are low-pressure vented. Dry start protection by self re-setting bi-metal disc-type thermal cut-out. Boil dry protection by manually re-settable disc-type bi-metal cut-out.

Installation

Retrofit Supreme retains the same footprint, service connections and wall fixings as previous Supreme models.

Installation Supreme units have a fixing template and hook-on brackets for wall mounting, ideally over a draining board or drip-tray. 150mm clearance should be allowed around the unit for maintenance (refer to instructions).

Plumbing Cold water feed should be taken directly from the mains – min pressure 0.5 bar (7psi) max pressure 10 bar (145psi). Bottom or rear entry using 15mm push-fit connections.

Electrical Supply (bottom or rear entry) can be taken from a suitable ring final circuit via a fused spur but must be via a double-pole linked isolating switch with a minimum break capacity of 10.5A.

All electrical work must comply with the latest IEE wiring regulations.

Supreme 220 SS / 250 SS / 310 SS / 560 SS

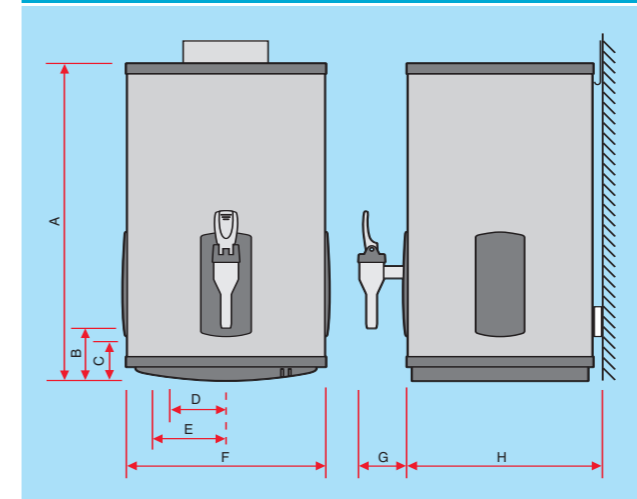

Dimensions								
Model	Height A mm	B mm	C mm	Cable D mm	E mm	Width F mm	G mm	Depth H mm
Supreme 220 SS	585	98	62	104	136	372	91	365
Supreme 250 SS	655	98	62	104	136	372	91	365
Supreme 310 SS	795	98	62	104	136	372	91	365
Supreme 560 SS	1000	98	62	104	136	372	91	365

Capacities					
Model	Cups (167ml)		Mugs (250ml)		Volume litres at one time
	per hr	at one time	per hr	at one time	
Supreme 220 SS	220	60	145	40	10
Supreme 250 SS	250	90	165	60	15
Supreme 310 SS	310	150	205	100	25
Supreme 560 SS	560	240	370	160	40

Specification

Capacities Supreme 220 SS 10.0l (max 220 cups/hr) Supreme 250 SS 15.0l (max 250 cups/hr) Supreme 310 SS (25.0l max 310 cups/hr) Supreme 560 SS 40.0l (max 560 cups/hr)

Rating Supreme 220 SS, 250 SS & 310 SS – 3.0kW @ 240V (2.8kW @ 230V). Supreme 560 SS – 6.0kW @ 240V (5.5kW @ 230V).

Outer casing Fingerprint resistant stainless steel with grey ABS mouldings.

Thermal insulation CFC/HCFC free (ODP zero) flame-retardant expanded polyurethane.

Water container Tin-plated copper, hinged access to element plate.

Heat unit Low watts density Superloy element(s) for long life.

Thermostat Electronic to control water temperature up to boiling point.

Safety features All models are low pressure vented. Dry start protection by self re-setting bi-metal thermal cut out. Boil dry by protection by manually re-settable disc-type bi-metal cut out.

Installation

Fixing Supreme units have a fixing template and hook-on brackets for wall mounting, ideally over a draining board or drip-tray. Clearance should be allowed above and below the unit for maintenance and either side if additional taps are to be fitted (refer to instructions). Hinged mounting bracket allows unit to swing forward for ease of service access.

Plumbing Cold water feed should be taken directly from the mains – min pressure 0.5 bar (7psi) max pressure 10 bar (145psi). Bottom or rear entry is possible using 15mm push-fit connections.

Electrical Supply (bottom or rear entry). 3kW units can be taken from a suitable ring final circuit via a fused spur but must be via a double-pole linked isolating switch with a minimum break capacity of 13A. 6kW units must be provided with their own dedicated supply.

All electrical work must comply with the latest IEE wiring regulations.

Approvals for all Supreme models

BEAB approved. kiwa approved to UK Water Supply Regulations. Manufactured in the UK in a BS EN ISO 9001:2000 registered factory.

BEAB Approved CE kiwa approved product

Guarantee for all Supreme models and accessories

Two year product guarantee with on-site service support from date of purchase. For more detailed guarantee information contact Heatrae Sadia.

2 YEAR GUARANTEE

Ordering guide

Model	Rating @240V	Capacity litres	Product code
Supreme 140	2.5	2.5	95:200:140
Supreme 155	2.5	5.0	95:200:141
Supreme 170	2.5	7.5	95:200:142
Supreme 150 SS	2.5	2.5	95:200:240
Supreme 165 SS	2.5	5.0	95:200:241
Supreme 180 SS	2.5	7.5	95:200:242
Supreme 220 SS	3.0	10	95:200:243
Supreme 250 SS	3.0	15	95:200:244
Supreme 310 SS	3.0	25	95:200:245
Supreme 560 SS	6.0	40	95:200:246

Our unique commitment to customer satisfaction includes free technical advice and installation guidance to ensure that Supreme is installed and functioning correctly. A team of over 25 field sales managers is available to meet specifiers and distributors on site and discuss products and installation issues. They are supported by a dedicated telephone call centre which offers technical advice. In addition, all Supreme products come with a full two-year on-site parts and labour guarantee giving users real peace of mind.

Spare parts will be available for eight years after the range has ceased production and are available from a network of nationwide stockists. The modular construction of Supreme means that every component is readily serviceable.

HEATRAE SADIA

The quality name in water heating

Products

Boiling water Supreme | Supreme SS

Chilled water SuperChill

Cistern-fed water heating Megalife HE | Megalife Solar

Cistern-type water heating FBM

Electric flow boiler Amptec | Electromax

Electric showers Accolade | Carousel | Sapphire | Cameo

Hand hygiene Handy | Concept | Hair Drier | Handy Dri

Immersion heaters Titanium | Superloy | Gold Dot | Maxistore | RDT Thermostats

Point of use Streamline | Express | UTC 99 | B3M | C3M | Vented tap range

Small unvented water heating Hotflo | Multipoint

Unvented water heating Megaflo HE | Megaflo HE SystemFit | Megatech Solar

For free product brochure(s) call our literature hotline on 01603 420127

Contact

Specification T: 01603 420220 F: 01603 420229 E: specifier@heatraesadia.com

Sales T: 08700 603262 F: 08700 600403 E: sales@heatraesadia.com

Service T: 08701 600125 F: 08701 600181 E: heatraesadiaservice@heateam.co.uk

Web www.heatraesadia.com

National service network

Heatrae Sadia products are inherently reliable and are designed to meet the demanding needs of all users.

A nationwide network of experienced engineers is available to provide fast and efficient on-site service support.

In addition, spare parts for the complete range of products are readily available through a wide variety of stockists.



Heatrae Sadia Heating Hurricane Way Norwich Norfolk NR6 6EA

Heatrae Sadia Heating may introduce modifications to their products from time to time. Consequently, the details given in this brochure are subject to alteration without notice.

95 900 851 Issue 8 © Heatrae Sadia Heating. January 2007.

A division of BAXI GROUP